

SURVEY CONTROL DATA
SEE PLAN & PROFILE SHEET

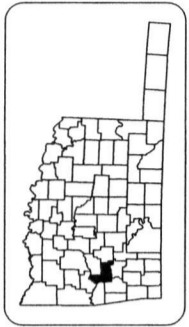

DESIGN DATA

AOT 2020	=	100
AOT 2040	=	150
V	=	40 MPH

SCALES

PLAN 1" = 100'
PROFILE HORIZ. 1" = 100'
PROFILE VERT. 1" = 10'
LAYOUT MAP 1" = 1 MILE

- CONVENTIONAL SYMBOLS**
- PROPOSED ROAD
 - PAVEMENT
 - RAILROAD
 - SECTION LINE
 - TOWNSHIP
 - SECTION LINE
 - TRACT
 - GROUND LINE
 - EXISTING ROAD
 - RAILROAD
 - TELEPHONE AND TELEGRAPH
 - POWER LINES
 - WATER LINES
 - DRAINAGE STRUCTURES (Existing)
 - DRAINAGE STRUCTURES (New)
 - RIGHT OF WAY LINES (Existing)
 - RIGHT OF WAY LINES (New)
 - RIGHT OF WAY MARKERS (In Place)
 - RIGHT OF WAY MARKERS (New)
 - CONTROL OF WAY EASEMENTS
 - RIGHT OF WAY EASEMENTS

2019 OKLAHOMA STANDARD SPECIFICATIONS FOR HIGHWAY CONSTRUCTION--ENGLISH GOVERN,
APPROVED BY THE U.S. DEPARTMENT OF TRANSPORTATION, FEDERAL HIGHWAY ADMINISTRATION
SEPTEMBER 1, 2020.

STATE OF OKLAHOMA
DEPARTMENT OF TRANSPORTATION
PLAN OF PROPOSED
COUNTY BRIDGE
STATE AID PROJECT NO. STP-251D(136)CI
BRIDGE & APPROACH PLANS
MUSKOGEE COUNTY
STATE JOB NO. 33053(04)
LOCATION 51N4090E0850009
EXISTING NBI NO. 09568, NEW NBI NO. 32508
LAT: 35°46'14"N LONG: 95°43'51"W

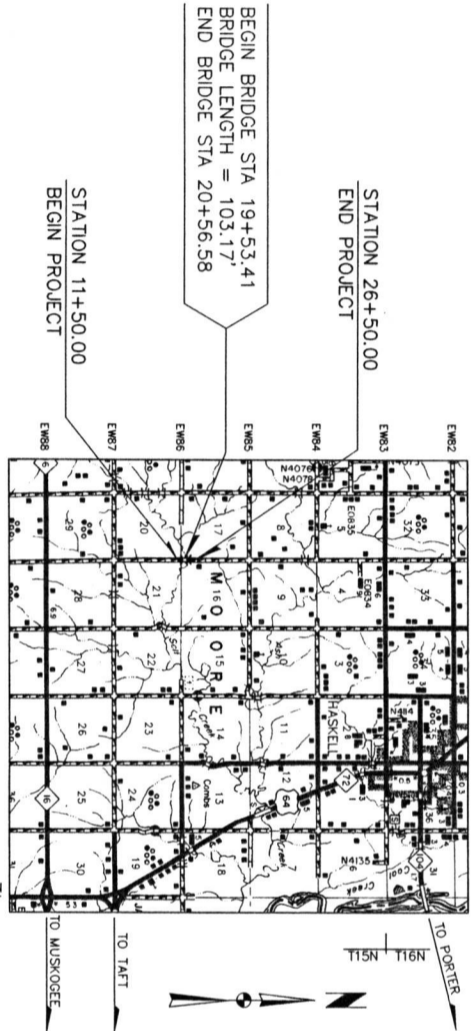

BEGIN BRIDGE STA 19+53.41
BRIDGE LENGTH = 103.17'
END BRIDGE STA 20+56.58

STATION 11+50.00
BEGIN PROJECT

STATION 26+50.00
END PROJECT

ROADWAY LENGTH 1396.83 FT 0.265 MI
BRIDGE LENGTH 103.17 FT 0.019 MI
PROJECT LENGTH 0.284 MI

EQUATIONS NONE
EXCEPTIONS NONE

DESCRIPTION	REASON	DATE

INDEX OF SHEETS

0001	TITLE SHEET
0002	TYPICAL SECTION
AB01	SUMMARY OF PAY QUANTITIES & NOTES (BRIDGE)
AE01	ENVIRONMENTAL NOTES
AR01	SUMMARY OF PAY QUANTITIES & NOTES (ROADWAY)
AT01	SUMMARY OF PAY QUANTITIES & NOTES (TRAFFIC)
AX01	SUMMARY SHEET
BO01	GENERAL PLAN & ELEVATION
BO02, BO03	FOUNDATION REPORT
BO04	SUBSTRUCTURE LAYOUT & SUMMARY OF PAY QUANTITIES
RO01	DRAINAGE AREA MAP
RO02	STORMWATER MANAGEMENT PLAN
RO03	SEDIMENT CONTROL AND FENCING PLAN
RO04, RO05	PLAN AND PROFILE SHEET
SO01, SO02	SURVEY DATA SHEET
TO01	TRAFFIC CONTROL PLAN
X001-X005	CROSS SECTIONS

STANDARDS REQUIRED TO CONSTRUCT THIS PROJECT

ROADWAY	TRAFFIC	BRIDGE
SSS-2-0	DU1-1-00	CB26-C-SKO-ABUT-PC4-02E
TC02-4-0	DU2-1-00	CB26-C-SKO-XSECT-PC234-01E
TSD-3-0	SKT-1-00	CB26-C-SKO-LSECT-PC8-01E
PCS-3-0	GHM1-1-00	CB26-C-SKO-DKSLB-BLST-01E
SP1-5-0	GHM2-1-00	CB26-C-SKO-PA-BND-PC234-01E
SPB-2-0	DBF2-1-00	CB26-C-SKO-SPR-QUAN-PC8-1-01E
FHTMPP-2-0	TCSS3-1-01	CB26-C-SKO-SPR-QUAN-PC8-2-01E
PUD-4-0	TCSS4-1-01	CB26-C-SKO-30-PC8-IV-100-01E
RF1-4-0	TCSS5-1-00	CB26-C-SKO.30-BRG-PC4-01E
RFW1-3-0	TCSS9-1-00	CB26.32-C-SKO-WING-PC4-01E
RFW2-3-0	TCSS10-1-00	CB26.32-C-SKO-ABUT-MISC-01E
	TCSS14-1-00	CB26.32-C-I-SKO.30-GR4U-BC-00E
		TR3-2-01E
		EJ-DTL-02E
		HP1-2-01E

APPROVED THIS _____ DAY OF _____ 2021

BOARD OF COUNTY COMMISSIONERS
MUSKOGEE COUNTY, OKLAHOMA

CHAIRMAN _____
MEMBER _____
MEMBER _____
ATTEST _____
COUNTY CLERK

Kenny Payne
COUNTY CLERK

HOLLOWAY, UPRINE & BELLEN, INC.
1000 N. W. 21st St.
Tulsa, Oklahoma 74104
PE NO. 24031

Wesley M. Stewart
WESLEY M. STEWART
PE NO. 24031

OKLAHOMA
DEPARTMENT OF TRANSPORTATION

DATE APPROVED _____ BY _____
CHIEF ENGINEER

OKLAHOMA
DEPARTMENT OF TRANSPORTATION
FEDERAL HIGHWAY ADMINISTRATION

DATE APPROVED _____ BY _____
DIVISION ADMINISTRATOR

Sheet No. 0001