

Fiscal Recovery Funds
Expenditure Documentation

Date 10/31/2022

MUSKOGEE County, Oklahoma

Identify the need or risk

District 3 has the need for equipment to be stored in place that provides security and protection from the elements so that it may be able to respond to any needs in a timely, efficient manner.

How does the proposed expenditure respond to the need or risk?

District 3 will build an equipment shed to securely store equipment to protect it from theft and vandalism. It will also provide protection from the elements to insure the efficient operation of the equipment at all times.

Expenditure Category Infrastructure

Expenditure: detail level 6.1 Provision of Government Services

FAQ number (if applicable)

Estimated amount of expenditure 57,790.89



Submitted to Governing Board by Kenny Payne, District 3 Commissioner

Board Signatures

Date

Approved

Denied

Reason for denial: _____

Purchase Order number (if applicable) _____

Notes _____

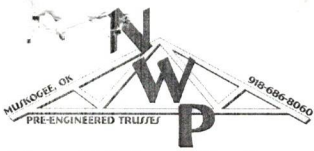

Newell Wood Products

Mail: P.O. Box 2873, Muskogee, OK 74402
 Location: 6290 Hwy 69 N, Porter, OK 74454
 Phone: (918) 686-8060 Fax: (918) 686-7420

Newell Wood Products
 www.newellwp.com

INVOICE

Invoice #

Date

Delivery Date

9/30/2022

Customer Information

Name: Star Fields
 Address:
 City, State, Zip:
 Phone:

Description: 30x150x12

Directions:

Line #	Qty	Length (ft.)	Metal Panels	Gauge	Color	Unit Price	Amount
001	50	31'0"		26		\$135.63 per piece	\$ 6,781.50
002	50	12'0"		29		\$40.20 per piece	\$ 2,010.00
003	2	12'1"		29		\$40.48 per piece	\$ 80.96
004	2	12'3"		29		\$41.04 per piece	\$ 82.08
005	2	12'6"		29		\$41.88 per piece	\$ 83.76
006	2	12'9"		29		\$42.71 per piece	\$ 85.42
007	2	13'0"		29		\$43.55 per piece	\$ 87.10
008	2	13'3"		29		\$44.39 per piece	\$ 88.78
009	2	13'6"		29		\$45.23 per piece	\$ 90.46
010	2	13'9"		29		\$46.06 per piece	\$ 92.12
011	2	14'0"		29		\$46.90 per piece	\$ 93.80
012	2	14'3"		29		\$47.74 per piece	\$ 95.48



Line #	Qty	Length (ft.)	Metal Trim	Notes	Color	Unit Price	Amount
001	4	16'6"	Corner/Rake 16'6"			\$52.35 per piece	\$ 209.40
002	2	14'6"	Corner/Rake 14'6"			\$46.01 per piece	\$ 92.02
003	2	12'6"	Corner/Rake 12'6"			\$39.66 per piece	\$ 79.32
004	15	10'0"	Fascia			\$20.57 per piece	\$ 308.55
005	15	10'0"	J - Trim			\$9.32 per piece	\$ 139.80
006	21	10'0"	Rat Guard			\$9.32 per piece	\$ 195.72
007	15	10'2"	3x3			\$14.24 per piece	\$ 213.60

31st day of Oct 2022
 Chairman
 Member
 Attest
 County Clerk

Line #	Qty	Length (ft.)	Lumber	Notes	Unit Price	Amount
001	52	18'	6x6x18 Tr		\$89.70 per piece	\$ 4,664.40
002	52	16'	6x6x16 Tr		\$67.60 per piece	\$ 3,515.20
003	3	20'	2x6x20 #2 SP Tr		\$18.20 per piece	\$ 54.60
004	9	20'	2x6x20 #3 SP		\$12.74 per piece	\$ 114.66
005	10	12'	2x6x12 #2 SP Tr		\$12.48 per piece	\$ 124.80
006	30	12'	2x6x12 #3 SP		\$7.80 per piece	\$ 234.00
007	2	16'	2x6x16 #2 SP Tr		\$14.56 per piece	\$ 29.12
008	6	16'	2x6x16 #3 SP		\$9.78 per piece	\$ 58.68
009	119	12'	2x8x12 #1 SP		\$14.04 per piece	\$ 1,670.76
010	16	16'	2x8x16 #1 SP		\$21.50 per piece	\$ 344.00
011	39	20'	2x8x20 #2 SP		\$20.80 per piece	\$ 811.20
012	136	20'	2x4x20 #3 SP		\$11.10 per piece	\$ 1,509.60
013	22	10'	2x4x10 #3 SP		\$5.20 per piece	\$ 114.40

Line #	Qty	Accessories	Notes	Unit Price	Amount
001	2	16G Nails		\$120.00 per piece	\$ 240.00

002	2	40 Pole Barn Nails G	\$130.00	per piece	\$	260.00
003	18	Screws: Metal/Wood	\$17.00	per piece	\$	306.00
004	3	Screws: Metal/Metal	\$22.00	per piece	\$	66.00
005	10	Screws: Metal/Wood	\$17.00	per piece	\$	170.00
006	50	Upper Closures	\$1.00	per piece	\$	50.00
007	50	Lower Closures	\$1.00	per piece	\$	50.00
008	40	butyl tape	\$7.34	per piece	\$	293.60

NOTICE TO OWNER: Failure of the billed party to pay those persons supplying material or services to complete this project can result in the filing of a mechanic's lien of the property.

BACK CHARGE NOTICE: Backcharges will not be accepted, regardless of fault, without prior notification and approval.

Subtotal	\$	25,590.89
Tax of 5.80%		
Delivery Fee	\$	300.00
Total	\$	25,890.89
Deposit		
Amount Due	\$	25,890.89

Thank you for your business.

COD

2022

Received By _____

Date _____

Labor 17400.00
 25898
~~25898~~
 43298.00

6300 concrete
 58898

no walks

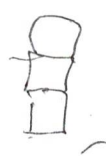

318 day of Oct 2022
 Chairman Henry W. Pan
 Member [Signature]
 Member [Signature]
 Attest [Signature]

American Native International Clerk

Management & Design General Contractors

Serving All Of Oklahoma
 Office: 918-683-0387
 Cell: 918-391-3520

Name: Muskogee County
 Address:
 City: Muskogee
 Phone:

We send Certified Journeyman
 Workers For Better Looking
 Longer Lasting Jobs

Date: 10-28-20

Description Of Work To Be Performed

~~XXXXXXXXXX~~

BOLD TO		SHIP TO	
ADDRESS		ADDRESS	
CITY, STATE, ZIP		CITY, STATE, ZIP	
CUSTOMER ORDER NO.	SOLD BY	TERMS	F.O.B. DATE
ORDERED	SHIPPED	DESCRIPTION	PRICE UNIT AMOUNT
		30 X 150 with 30 by 30 bag of concrete wall 6" on floor concrete	31,900.00 Each

