



SHELLY SUMPTER

Muskogee County Treasurer

10th day of April 20 23  
Chairman \_\_\_\_\_  
Member \_\_\_\_\_  
Member \_\_\_\_\_  
Attest \_\_\_\_\_  
County Clerk

**Tax Deputies**  
Jaime Duerson  
Brenda Fullwood  
Montana Leal  
Laura Stewart

**Bookkeeping Deputies**  
Jessica Duerson  
Lacy Rosson

**1st Deputy**  
Sarah Hernandez

**Office Manager/  
Tax Supervisor**  
Jessica Smith

**Law Enforcement  
Deputy**  
Sheila Dause  
**Assistant Deputy**  
Jaclyn Watson

March 29, 2023



Board of County Commissioners  
400 W. Broadway, Suite #100  
Muskogee, OK 74401

RE: Request for conveyance of County-owned property by City of Muskogee

Dear Sirs,

City of Muskogee has requested the following parcel:

- PID #4610-26-190-006-1-158-22  
Legal Description: MUSKOGEE OT LOTS 1 & 2 BLOCK 190  
SUBDIVISION LOT 6  
Physical Address: 225 N 9; Muskogee, OK

This property was acquired by the County through the 2021 tax lien sale. Please see the attached property record card and block & street map for more info on this parcel.

This property is now eligible for a Commissioner's Sale or may be declared as excess property and deeded.

Thank you,

*Shelly Sumpter*  
Shelly Sumpter  
Muskogee County Treasurer

March 1, 2023

Muskogee County Commissioner's  
County Services Building  
P.O. Box 2307  
Muskogee, OK 74401

RE: Parcels of land to be conveyed to the City

Dear Commissioners:

I am requesting that the County convey the attached described properties to the City of Muskogee. The properties have been acquired in the name of the County from delinquent tax sale.

Muskogee OT Lots 1 and 2 Block 190 Subdivision Lot 6

Could you please place this conveyance on your next available agenda? If you have any questions, please call 918-684-6276. Thanking you in advance for your cooperation.

Sincerely,

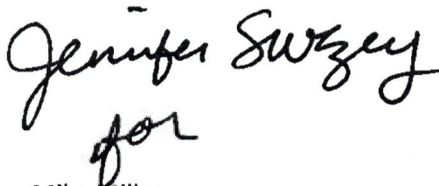

for  
Mike Miller  
City Manager

1-2021-015509 Book 4775 Pg: 242  
 11/30/2021 2:33 pm Pg 0242-0243  
 Fee: \$ 0.00 Doc: \$ 0.00  
 Polly Irving - Muskogee County Clerk  
 State of Oklahoma

*Corrected Book 4750 Page 880*

**COUNTY TREASURER'S RESALE DEED**  
 (COUNTY)

WHEREAS, SHELLY SUMPTER, County Treasurer  
 of MUSKOGEE COUNTY, State of Oklahoma, on June 15, 2021  
 sold separately and singly, in the manner provided by law, at tax resale and SHELLY SUMPTER  
 County Treasurer of said County bid in for the County the real estate hereinafter described, and

WHEREAS, all proceedings, notices and duties provided, required and imposed by law prerequisite to the vesting of authority in  
 said County Treasurer to execute this resale deed have been followed, given, complied with and performed, and

WHEREAS, the said SHELLY SUMPTER, MUSKOGEE COUNTY, Treasurer  
 is now by law vested with power and authority to execute this resale deed,

NOW, THEREFORE, this indenture made on November 23, 2021, between  
 the State of Oklahoma, by SHELLY SUMPTER, the Treasurer of  
MUSKOGEE COUNTY, of the first part, KEITH HYSLOPE,

Chairperson of the Board of County Commissioners of said County, of the second part, witnesseth, that the said party of the first part  
 for and in consideration of the premises and the cancellation of all the taxes, penalties, interest and costs heretofore levied and  
 assessed against the real estate hereinbelow described, hath granted, bargained and sold, and by these presents doth grant, bargain,  
 sell, and convey to the said party of the second part, his (or her) heirs, executors, administrators, and assigns, forever, the following  
 separately described tracts, parcels, or lots of land so sold separately and singly for the amount of taxes, interest, penalties and costs  
 cancelled in the total sum set opposite each, all of said tracts, parcels, or lots of land being located in

MUSKOGEE COUNTY, Oklahoma, to-wit:

| DESCRIPTION   | City, Town or Subdivision<br>BaseID | Sec. | Twp. or Blk. | Rng. or Lot | Amount<br>(Bid on each) |
|---|-------------------------------------|------|--------------|-------------|-------------------------|
| 225 N 9<br>MUSKOGEE OT LOTS 1 & 2 BLOCK 190 SUBDIVISION LOT 6 | MUSKOGEE<br>2188                    | 22   | 01           | 58          | 0.00                    |

To have and to hold said tracts and parcels of land with the appurtenances thereto belonging to said party of the second part,  
 his (or her) heirs, executors, administrators, and assigns, forever, in as full and ample manner as the said Treasurer of said County is  
 empowered by law to sell the same.

In testimony whereof, the SHELLY SUMPTER, Treasurer of said  
MUSKOGEE COUNTY, State of Oklahoma, has hereunto set his (or her) hand and seal the day and year  
 aforesaid.

ATTEST:  
 (SEAL)



STATE OF OKLAHOMA  
 By *Shelly Sumpter*  
 County Treasurer

ACKNOWLEDGMENT

I-2021-015509 Book 4775 Pg: 243  
11/30/2021 2:33 pm Pg 0242-0243  
Fee: \$ 0.00 Doc: \$ 0.00  
Polly Irving - Muskogee County Clerk  
State of Oklahoma

STATE OF OKLAHOMA

MUSKOGEE COUNTY

} ss.

Before me, the undersigned, a Notary Public, within and for the above named County and State, on November 23, 2021 personally appeared SHELLY SUMPTER to me known to be the County Treasurer of MUSKOGEE COUNTY, Oklahoma, and the identical person who executed the within and foregoing instrument and conveyance of land, and acknowledged to me that he or she executed the same in his or her capacity as County Treasurer of MUSKOGEE COUNTY, Oklahoma as his or her free and voluntary act and deed as such, and as the free and voluntary act and deed of MUSKOGEE COUNTY, and the State of Oklahoma, for the uses and purposes therein set forth.

Witness my hand and notarial seal the day and year above written.

SARAH ELIZABETH HERNANDEZ-CORONA  
NOTARY PUBLIC - STATE OF OKLAHOMA  
COMMISSION EXPIRES MAR. 16, 2025  
COMMISSION # 21003588

*Sarah Hernandez*

Notary Public  
(Or County Clerk)

My commission expires

03/16/25

No. \_\_\_\_\_

COUNTY TREASURER'S  
RESALE TAX DEED

FROM \_\_\_\_\_ COUNTY  
STATE OF OKLAHOMA  
TO

STATE OF OKLAHOMA, } ss.  
County

Filed in the office of County Clerk for record  
on this day of \_\_\_\_\_  
at \_\_\_\_\_, and recorded in  
Book \_\_\_\_\_ of \_\_\_\_\_ on page \_\_\_\_\_

County Clerk  
By \_\_\_\_\_ Deputy

**COUNTY TREASURER'S RESALE DEED**  
 (COUNTY)

WHEREAS, ROBYN BOSWELL, County Treasurer  
 of MUSKOGEE COUNTY, State of Oklahoma, on June 15, 2021,  
 sold separately and singly, in the manner provided by law, at tax resale and ROBYN BOSWELL  
 County Treasurer of said County bid in for the County the real estate hereinafter described, and

WHEREAS, all proceedings, notices and duties provided, required and imposed by law prerequisite to the vesting of authority in  
 said County Treasurer to execute this resale deed have been followed, given, complied with and performed, and

WHEREAS, the said ROBYN BOSWELL, MUSKOGEE COUNTY, Treasurer  
 is now by law vested with power and authority to execute this resale deed,

NOW, THEREFORE, this indenture made on July 2, 2021, between  
 the State of Oklahoma, by ROBYN BOSWELL, the Treasurer of  
MUSKOGEE COUNTY, of the first part, KEITH HYSLOPE,

Chairperson of the Board of County Commissioners of said County, of the second part, witnesseth, that the said party of the first part  
 for and in consideration of the premises and the cancellation of all the taxes, penalties, interest and costs heretofore levied and  
 assessed against the real estate hereinbelow described, hath granted, bargained and sold, and by these presents doth grant, bargain,  
 sell, and convey to the said party of the second part, his (or her) heirs, executors, administrators, and assigns, forever, the following  
 separately described tracts, parcels, or lots of land so sold separately and singly for the amount of taxes, interest, penalties and costs  
 cancelled in the total sum set opposite each, all of said tracts, parcels, or lots of land being located in

MUSKOGEE COUNTY, Oklahoma, to-wit:

| DESCRIPTION   | City, Town or Subdivision<br>BaseID | Sec. | Twp. or Blk. | Rng. or Lot | Amount<br>(Bid on each) |
|---|-------------------------------------|------|--------------|-------------|-------------------------|
| 225 N 9<br>MUSKOGEE OT LOTS 1 & 2 BLOCK 190 SUBDIVISION LOT 6<br>UNDIVIDED 1/3 INTEREST | MUSKOGEE<br>2188                    | 0-   | -26          | -19         | 0.00                    |

To have and to hold said tracts and parcels of land with the appurtenances thereto belonging to said party of the second part,  
 his (or her) heirs, executors, administrators, and assigns, forever, in as full and ample manner as the said Treasurer of said County is  
 empowered by law to sell the same.

In testimony whereof, the ROBYN BOSWELL, Treasurer of said  
MUSKOGEE COUNTY, State of Oklahoma, has hereunto set his (or her) hand and seal the day and year  
 aforesaid.

ATTEST:  
 (SEAL)



STATE OF OKLAHOMA

By Robyn Boswell  
 County Treasurer

ACKNOWLEDGMENT

STATE OF OKLAHOMA

MUSKOGEE COUNTY

} ss.

Before me, the undersigned, a Notary Public, within and for the above named County and State, on July 2, 2021  
personally appeared ROBYN BOSWELL  
to me known to be the County Treasurer of MUSKOGEE COUNTY, Oklahoma, and the  
identical person who executed the within and foregoing instrument and conveyance of land, and acknowledged to me that  
he or she executed the same in his or her capacity as County Treasurer of MUSKOGEE COUNTY, Oklahoma  
as his or her free and voluntary act and deed as such, and as the free and voluntary act and deed of MUSKOGEE COUNTY  
, and the State of Oklahoma, for the uses and purposes therein set forth.

Witness my hand and notarial seal the day and year above written.



(SEAL)

My commission expires

1-6-2024

*Tammy East*

Notary Public  
(Or County Clerk)

No. \_\_\_\_\_

COUNTY TREASURER'S  
RESALE TAX DEED

FROM \_\_\_\_\_ COUNTY  
STATE OF OKLAHOMA  
TO

STATE OF OKLAHOMA, } ss.  
County

Filed in the office of County Clerk for record  
on this day of \_\_\_\_\_  
at \_\_\_\_\_, and recorded in  
Book \_\_\_\_\_ of \_\_\_\_\_ on page \_\_\_\_\_

By \_\_\_\_\_ County Clerk  
Deputy

From the Office of:

**SHELLY SUMPTER**  
**MUSKOGEE COUNTY TREASURER**  
PO BOX 1587  
MUSKOGEE, OK 74402-1587  
PHONE (918) 682-0811

# Tax Information

Real Estate

| School Dist | Tax Year       | Taxroll Item #     |
|-------------|----------------|--------------------|
| 20A         | 2022           | 2201               |
|             | Land Value     | 0                  |
|             | Improvements   | 0                  |
|             | Gross Assessed | 0                  |
|             | Exemptions     | 0                  |
| Orig Tax    | Adjustments    | Net Assessed       |
| 36.00       | -36.00         | Total Tax          |
|             |                | Total Tax Payments |
|             |                | 0.00               |
|             |                | 0.00               |

Parcel ID Number  
4610-26-190-006-1-158-22  
MUSKOGEE OT

Owner Name and Address 287467  
MUSKOGEE COUNTY-MC-RES  
P.O. BOX 2307  
MUSKOGEE OK 74402-0000

Situs/Legal Description:  
225 N 9 MUS  
MUSKOGEE OT LOTS 1 & 2 BLOCK 190 SUBDIVISION LOT 6

None Due \$0.00

Mortgage Holder  
MC-RES  
MUSKOGEE COUNTY  
RESALE

**BDF**

## Adjustments

| Entered   | Cert Date | Cert     | Land Value | Improvements | Mobile Home | Exemptions | Tax Amount |
|-----------|-----------|----------|------------|--------------|-------------|------------|------------|
| 3/14/2023 | 3/14/2023 | CERT 137 | -365       |              |             |            | -36.00     |

DID NOT CHANGE TO EXEMPT WHEN CHANGING THE DEED

As of: 3/28/2023

**Property Owner****Name:** MUSKOGEE COUNTY-MC-RES**Mailing Address:** P.O. BOX 2307  
MUSKOGEE, OK 74402-**Type:** (EX) Exempt**Tax Dist:** (32) 20A-MUSKOGEE**Size (Acres):** 0.000**Extended Legal:** MUSKOGEE OT LOTS 1 &; 2 BLOCK 190 SUBDIVISION LOT 6**Property Information****Physical Address:** 225 N 9**Subdivision:** MUSKOGEE OT**Block / Lot:** 0190 / 0006**S-T-R:** N/A**Market and Assessed Values:**

|                  | <b>Taxable<br/>Market Value</b> | <b>Full Assessed<br/>(11.00% Market<br/>Value)</b> |
|------------------|---------------------------------|--|
| <b>Land:</b>     | \$0                             | \$0  |
| <b>Building:</b> | 0                               | 0  |
| <b>Total:</b>    | \$0                             | \$0  |

**Land:**

| <b>Land Use</b> | <b>Size</b> | <b>Units</b> |
|-----------------|-------------|--------------|
|                 | 9100        | Square-Feet  |

**Deed Transfers:**

| <b>Date</b> | <b>Book</b> | <b>Page</b> | <b>Deed Type</b> | <b>Stamps</b> | <b>Est. Sale</b> | <b>Grantee</b>                   | <b>Code</b> | <b>Type</b> |
|-------------|-------------|-------------|------------------|---------------|------------------|----------------------------------|-------------|-------------|
| 11/23/2021  | 4775        | 242         | Leaves           | 0.00          | \$0              | WILLIAMS, LYRANITA D             | E           |             |
| 8/25/2016   | 4504        | 883         | D                | 0.00          | \$0              | ANDERSON, JERRY & CARMEN<br>ETAL |             |             |
| 1/29/2016   | 4475        | 173         | D                | 0.00          | \$0              | WILLIAMS, LYRANITA D             |             |             |
| 4/25/2013   | 4329        | 171         | D                | 0.00          | \$0              | EMBRY, CAROLYN                   |             |             |
| 9/7/2000    | 2763        | 37          | Q                | 3.00          | \$2,000          | EMBRY, CAROLYN ETAL              | Valid       |             |
| 10/20/1999  | 2677        | 99          | Q                | 0.00          | \$0              | JOHNSTON, FRANK                  |             |             |
| 10/19/1999  | 2677        | 98          | W                | 5.25          | \$3,500          | MYERS, WILLIAM H &<br>MARCELLE   | Valid       |             |
| 1/1/1900    | 2076        | 103         |                  | 0.00          | \$0              | WOMEN IN SAFE HOMES INC          | Unval.      |             |





# Muskogee

## Assessment Property Record Card

Data provided by Ron Dean County Assessor

Date 03/28/2023  
 Time 15:08:39  
 Page 1

| Assessment Data        |                          |
|------------------------|--------------------------|
| Account                | 510002201                |
| Parcel ID              | 4610-26-190-006-1-158-22 |
| Cadastral ID           | 0001 0158 22             |
| Property Type          | REAL - Real Property     |
| Property Class         | E                        |
| Tax Area               | 32 - 20A-MUSKOGEE        |
| Name ID                | 287467                   |
| MUSKOGEE COUNTY-MC-RES |                          |
| P.O. BOX 2307          |                          |
| MUSKOGEE               | OK 74402-                |
| Parcel Location        |                          |
| Situs                  | 00225 N 9                |
| Subdivision            | MUSKOGEE OT              |
| Lot/Block              | 0006 / 0190              |
| Parcel Size            | 9100 - Square-Feet       |
| Sec/Twn/Rng            | / / /                    |
| Neighborhood           | 104 - Musk VI-1 Q-4      |
| School District        | I-20 - MUSKOGEE          |

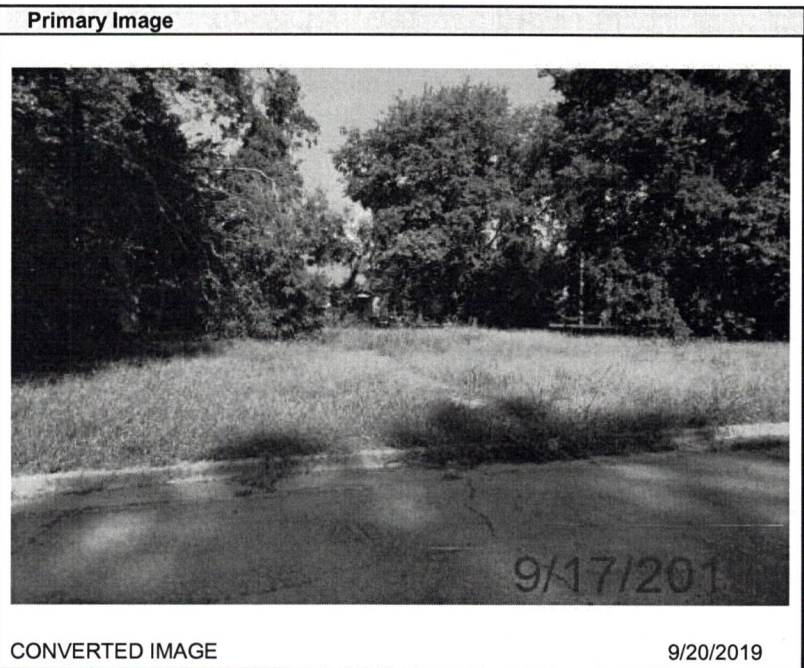

| Legal Description                                  |  |
|--|--|
| MUSKOGEE OT LOTS 1 & 2 BLOCK 190 SUBDIVISION LOT 6 |  |

| Building Permits |             |        |        |        |  |
|------------------|-------------|--------|--------|--------|--|
| Number           | Description | Opened | Closed | Amount |  |
|                  |             |        |        |        |  |

| Exemptions |      |        |         |           |
|------------|------|--------|---------|-----------|
| Code       | Type | Active | Maximum | Exemption |
|            |      |        |         |           |

| Sale History |                               |            |       |      |  |
|--------------|-------------------------------|------------|-------|------|--|
| Bk/Pg        | Grantor                       | Date       | Price | Code |  |
| 4775/242     | WILLIAMS, LYRANITA D          | 11/23/2021 | 0     | E    |  |
| 4504/883     | ANDERSON, JERRY & CARMEN ETAL | 08/25/2016 | 0     |      |  |
| 4475/173     | WILLIAMS, LYRANITA D          | 01/29/2016 | 0     |      |  |
| 4329/171     | EMBRY, CAROLYN                | 04/25/2013 | 0     |      |  |
| 2763/37      | EMBRY, CAROLYN ETAL           | 09/07/2000 | 2,000 | 1    |  |
| 2677/99      | JOHNSTON, FRANK               | 10/20/1999 | 0     |      |  |

| Parcel Valuation |      |              |        |             |          |           |               |             |      |
|------------------|------|--------------|--------|-------------|----------|-----------|---------------|-------------|------|
| Source           | REAL | Fair Cash    | Capped | Asmnt Level | Assessed | Levy Rate | 99.650        | Current Tax |      |
| Remove Cap       | 2022 | Land Value   | 3,320  | 0           | 11%      | 0         | Assessed      | 0           | 0.00 |
| Year Frozen      |      | Improvements | 0      | 0           |          | 0         | Penalty       | 0           |      |
| New Construction | 0    | Mobile Home  | 0      | 0           |          | 0         | Exemption     | 0           | 0.00 |
| TIF Project ID   | 0    | Total Value  | 3,320  | 0           |          | 0         | Total Taxable | 0           | 0.00 |

| Assessment History |                  |                        |          |             |            |               |            |  |
|--------------------|------------------|------------------------|----------|-------------|------------|---------------|------------|--|
| Tax Year           | Statement Number | Billed Owner           | Tax Area | Total Value | Exemptions | Taxable Value | Billed Tax |  |
| 2022               | 2022-510002201   | MUSKOGEE COUNTY-MC-RES | 32       |             | 0          |               | .00        |  |
| 2021               | 2021-510002201   | WILLIAMS, LYRANITA D   | 32       | 3,320       | 0          | 365           | 37.00      |  |
| 2020               | 2020-510002201   | WILLIAMS, LYRANITA D   | 32       | 3,320       | 0          | 365           | 37.00      |  |
| 2019               | 2019-0002201     | WILLIAMS, LYRANITA D   | 32       | 15,455      | 0          | 1,700         | 169.00     |  |
| 2018               | 2018-0002201     | WILLIAMS, LYRANITA D   | 32       | 15,455      | 0          | 1,700         | 166.00     |  |
| 2017               | 2017-0002201     | WILLIAMS, LYRANITA D   | 32       | 15,455      | 0          | 1,700         | 160.00     |  |
| 2016               | 2016-0002201     | WILLIAMS, LYRANITA D   | 32       | 15,455      | 0          | 1,700         | 162.00     |  |
| 2015               | 2015-0002201     | WILLIAMS, LYRANITA D   | 32       | 5,152       | 0          | 551           | 52.00      |  |
| 2014               | 2014-0002201     | WILLIAMS, LYRANITA D   | 32       | 5,152       | 0          | 525           | 50.00      |  |
| 2013               | 2013-0002201     | WILLIAMS, LYRANITA D   | 32       | 4,543       | 0          | 500           | 46.00      |  |
| 2012               | 2012-0002201     | EMBRY, CAROLYN         | 32       | 15,455      | 0          | 1,436         | 136.00     |  |
| 2011               | 2011-0002201     | EMBRY, CAROLYN         | 32       | 15,455      | 0          | 1,368         | 130.00     |  |
| 2010               | 2010-0002201     | EMBRY, CAROLYN         | 32       | 15,455      | 0          | 1,303         | 122.00     |  |



Show Detailed Report

Parcel ID

4610-26-190-006-1-158-22

RPID

510002201

Owner

MUSKOGEE COUNTY-MC-RES

Owner Address

P.O. BOX 2307 MUSKOGEE OK 74402-

CAMA Acreage

0

Parcel Address

225 N 9

Partial Legal

MUSKOGEE OT LOTS 1 & 2  
BLOCK 190 SUBDIVISION LOT 6

Total Value

0

Calculated GIS Area

0.2042 acres  
8,896.1652 sq feet  
0.0003 sq miles  
826.4816 sq meters  
0.0008 sq kilometers



